

wama 500

Treillis | RUWA Treillis de stock | dans de l'acier d'armature B500B

HX 424.51

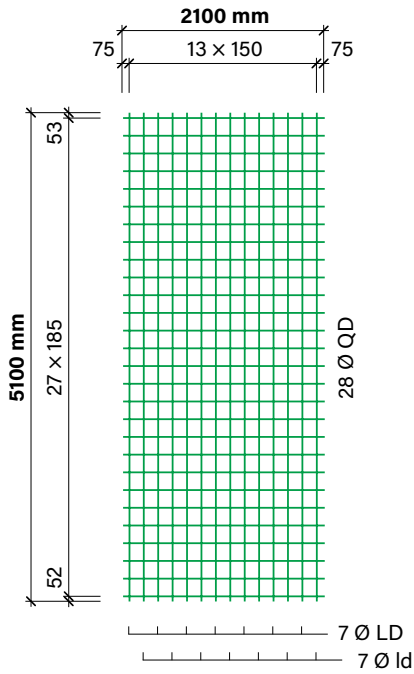

HX 424.63

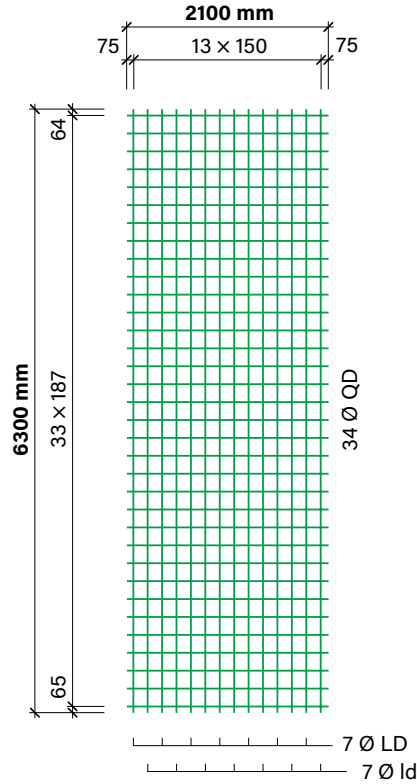

HW 335

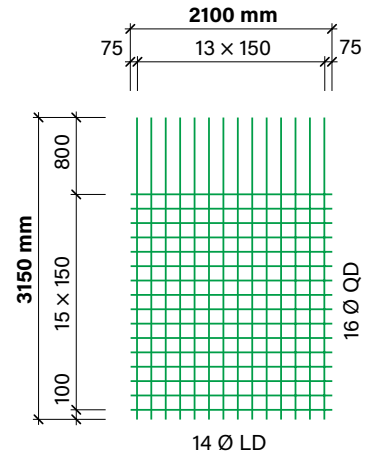

**HX 335.51
HX 523.51**

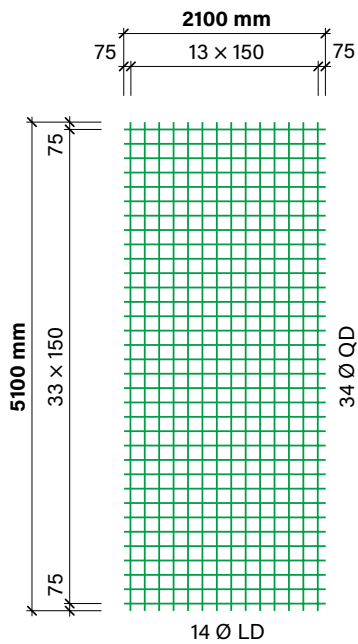

**HX 335.63
HX 523.63**

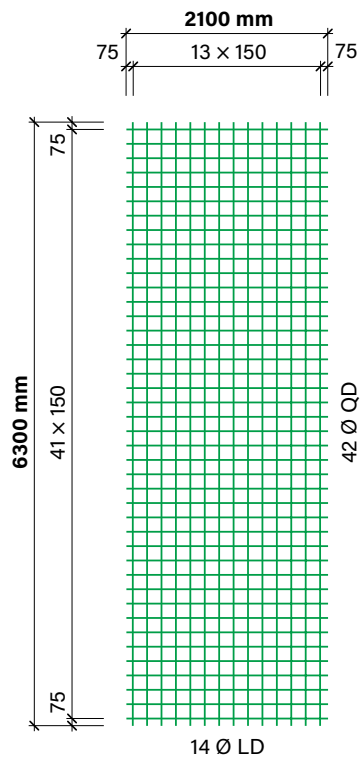

wama 500

Treillis | RUWA Treillis de stock | dans de l'acier d'armature B500B

Format L x l [m]	Type	Division		Diamètre		Section a _s		Recouvrement min.		Poids	
		longitudinal	transversal	ld / LD	QD	longitudinal	transversal	transversal l _b	longitudinal l _b	Treillis	m ²
		[mm]	[mm]	[mm]	[mm]	[mm ² /m]	[mm ² /m]	[mm]	[mm]	[kg]	[kg/m ²]

Treillis en acier d'armature B500B pour les armatures biaxiales

5.10 × 2.10	HX 335.51	150	150	8	8	335	335	350	350	56.4	5.27
6.30 × 2.10	HX 335.63	150	150	8	8	335	335	350	350	69.7	5.27
5.10 × 2.10	HX 424.51	150	185	8/10	10	424	424	400	400	71.3	6.65
6.30 × 2.10	HX 424.63	150	187	8/10	10	424	424	400	400	88.0	6.65
5.10 × 2.10	HX 523.51	150	150	10	10	523	523	400	400	88.1	8.23
6.30 × 2.10	HX 523.63	150	150	10	10	523	523	400	400	108.8	8.23

Treillis en acier B500B pour les armatures de parois

3.15 × 2.10	HW 335	150	150	8	8	335	335	350	-	30.7	4.64
-------------	---------------	-----	-----	---	---	-----	-----	-----	---	-------------	------

Désignation de treillis

La désignation de treillis comprend les paramètres suivants:

HX 335.63

